



© Matej Vozli?

The layout of the Dvorni trg square and the Hribarjevo nabrežje river banks is part of the broader design for the transformation of public areas along the Ljubljanica River, which has evolved gradually over the past decade. The layout of Hribarjevo nabrežje emphasises the flow of the river and continues, with pergolas and trees, to stress the Mediterranean features of the town, a principle earlier followed by Plešnik. Dvorni trg, a former parking area, is transformed into a useful urban space by means of step-cascades. The necessary access to collectors in the lower part of the square dictated the design of a wooden platform, which acts as a stage against the background silhouette of the Ljubljana Castle.

## Dvorni trg and Hribarjevo nabrežje

Dvorni trg  
1000 Ljubljana, Slowenien

ARCHITEKTUR  
**Matej Vozli?**  
**Vesna Vozli?**

BAUHERRSCHAFT  
**Town of Ljubljana**

FERTIGSTELLUNG  
**2002**

SAMMLUNG  
**Architekturarchiv Slowenien**

PUBLIKATIONSdatum  
**19. Februar 2006**



© Matej Vozli?

**Dvorni trg and Hribarjevo nabrežje**

DATENBLATT

Architektur: Matej Vozli?, Vesna Vozli?

Mitarbeit Architektur: Mateja Kri?ej, Klemen Vodnik, Tomaž Slak

Bauherrschaft: Town of Ljubljana

Funktion: Parkanlagen und Platzgestaltung

Planung: 1995 - 2000

Fertigstellung: 2002

g/1139400481.jpg

### Dvorni trg and Hribarjevo nabrežje

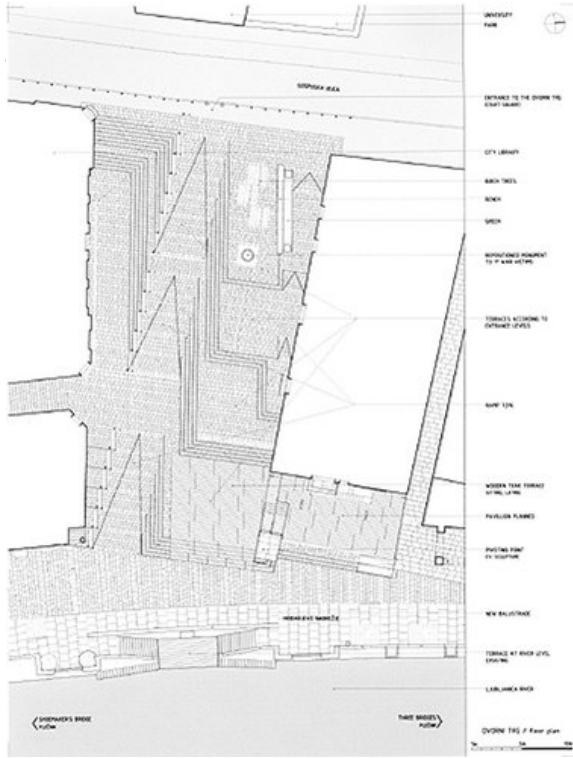

plan