



© Pavol Kovač

Church in Vojkovce

Vojkovce, Slovakia

ARCHITEKTUR
Albert Rybarčák

KUNST AM BAU
Vladimír Popovič

FERTIGSTELLUNG
1993

SAMMLUNG
Architekturarchiv Slowakei

PUBLIKATIONSdatum
23. April 2008



In the middle of the small village Vojkovce there is a little church of St. Bartholomew constructed at the place of the former chapel according to the project of the young architect from Prešov A. Rybarčák. Its composition was inspired by the Biblical story about Noah's Ark. The object consists of three parts: the rotunda, the aisle and the tower. Cylindrical entrance space with the circular windows was inspired by the Roman rotundas from the vicinity. Church aisle is sloping. Its interior is decorated by the painting representing dramatic scene of storm and rainbow (V. Popovič). The back tower functions as a bell-tower. Mature and rich forms, their distinguished expression, as well as proportional integration into the surroundings make the little church one of the best sacral buildings constructed after 1989. Henrieta Moravčíková



© Pavol Kovač



© Pavol Kovač

Church in Vojkovce

DATENBLATT

Architekt: Albert Rybarčák
Kunst am Bau: Vladimír Popovič

Funktion: Sakralbauten

Planung: 1990
Fertigstellung: 1993

PUBLIKATIONEN

Moravčíková, H. H.: Architekt Albert Rybarčák. Meritum, Bratislava 1995.
Kostolík vo Vojkovciach. Archit. a Urban. 29, 1995, 3-4, 86 - 89.
Moravčíková, H. H.: Kostolík vo Vojkovciach a jeho príbeh. SNG, Bratislava 1996.

Church in Vojkovce

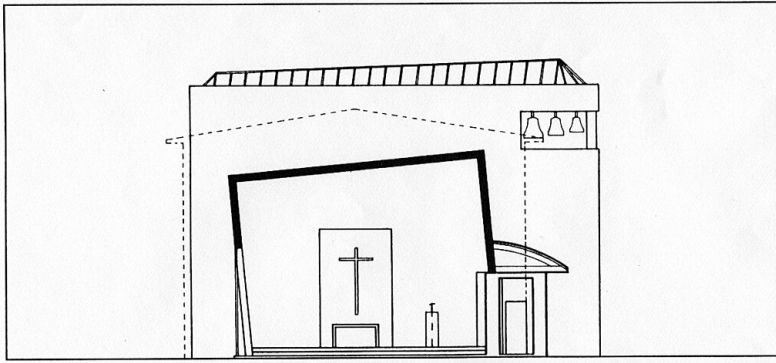

Section

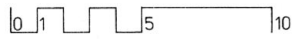
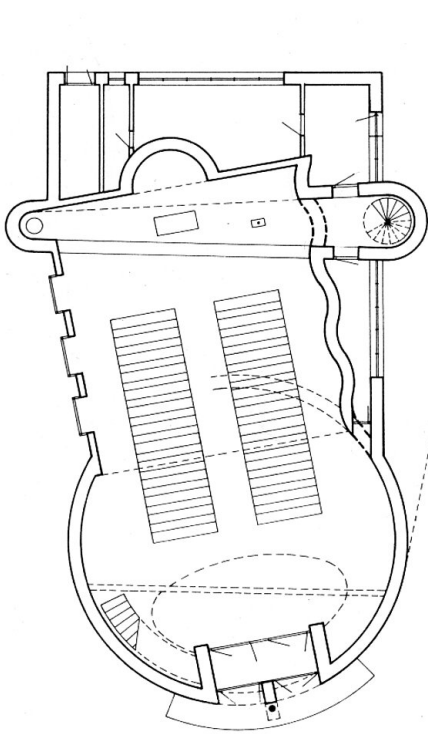

Plan